

Beni

Featured Elevation Style:
Prairie



About Beni

Fall in love with this timeless home, designed with the whole family in mind. The Beni's main floor features an open concept floor plan with a central kitchen that eases into the living and dining rooms. The mudroom is tucked away to save space, and the large dining room is perfect for family gatherings. The main floor features 9 ft. ceilings, and the home has a fantastic suite option. Upstairs you'll find two bedrooms, a laundry room, plus a master suite with a walk-in closet and five-piece ensuite.

1595 sq. ft.

3 Bed

2.5 Bath

Alternate Elevation
Craftsman Style



Contact Us
1 (780)-554-9937
sales@troiwestbuilders.com



Beni

Main Floor
827 sq. ft.

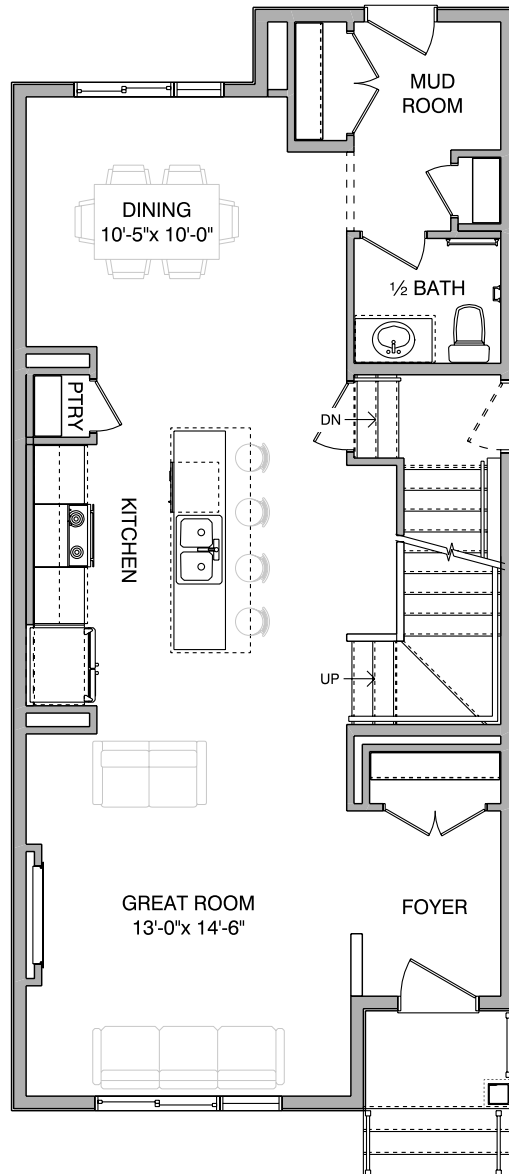

Second Floor
786 sq. ft.

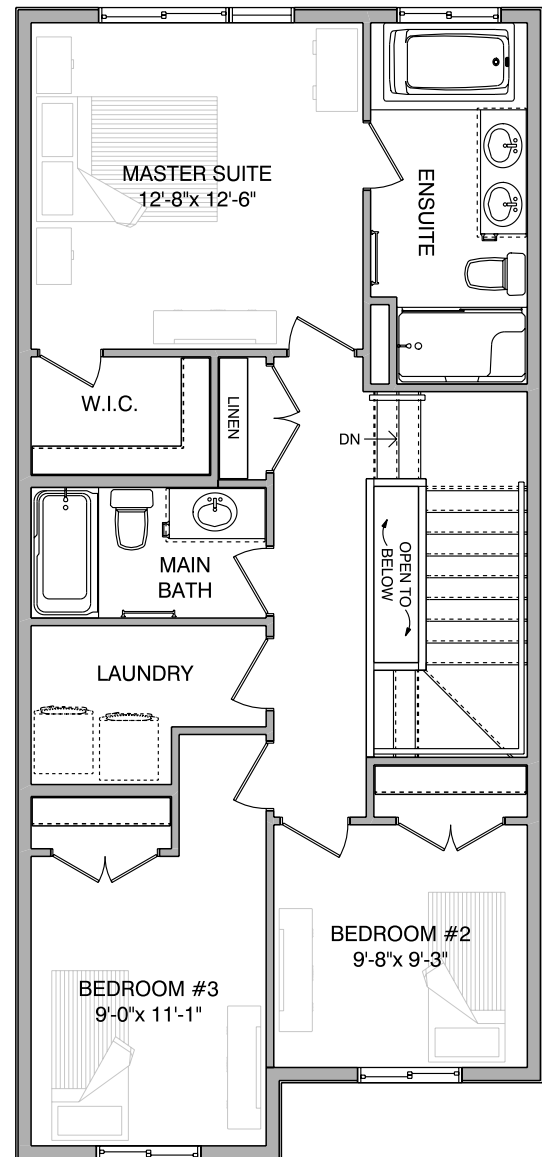

Notes

Contact Us
1 (780)-554-9937
sales@troiwestbuilders.com

TROIWEST
BUILDERS